

HONDA GL 1000 REAR AXLE BRACKETS INSTALLED

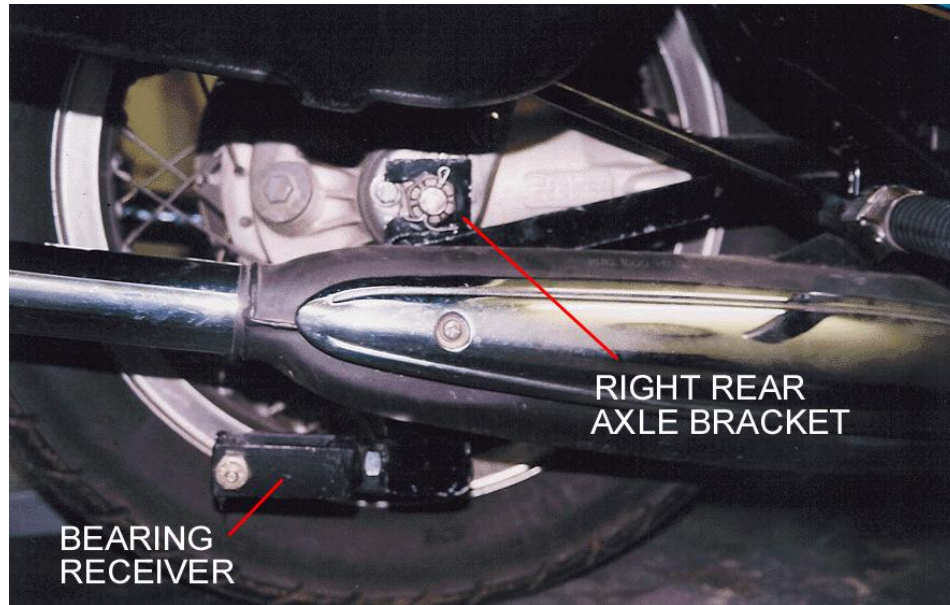

This Left Rear Axle Bracket is
for the '75 & '77 Honda GL 1000

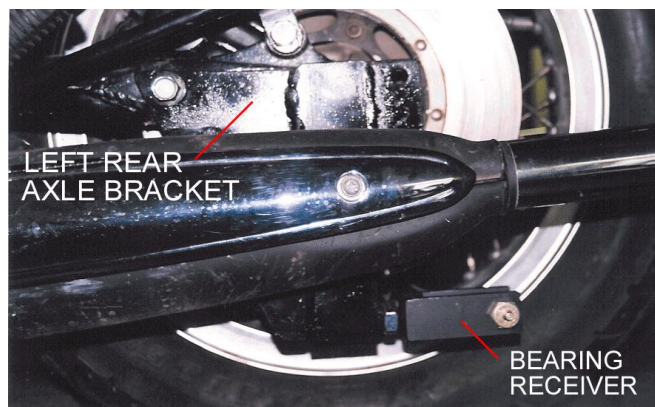

HONDA GL 1000 BELLY BRACKET INSTALLED

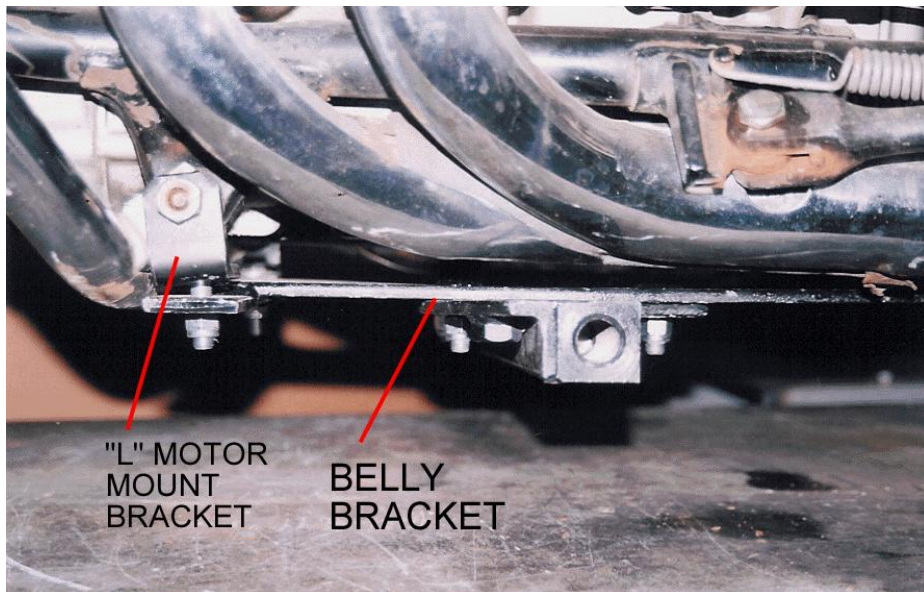
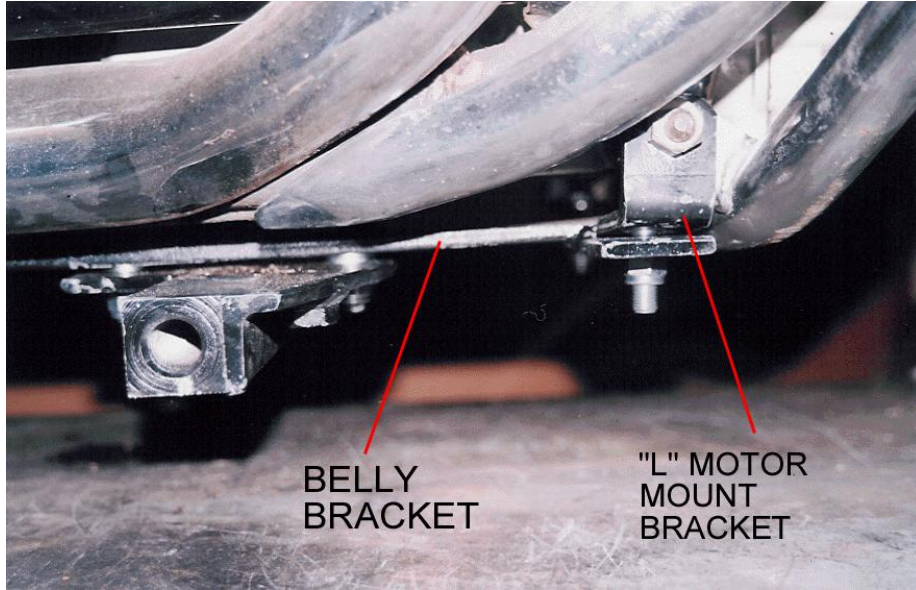

HONDA GOLDWING 1000 DESCRIPTION OF PARTS

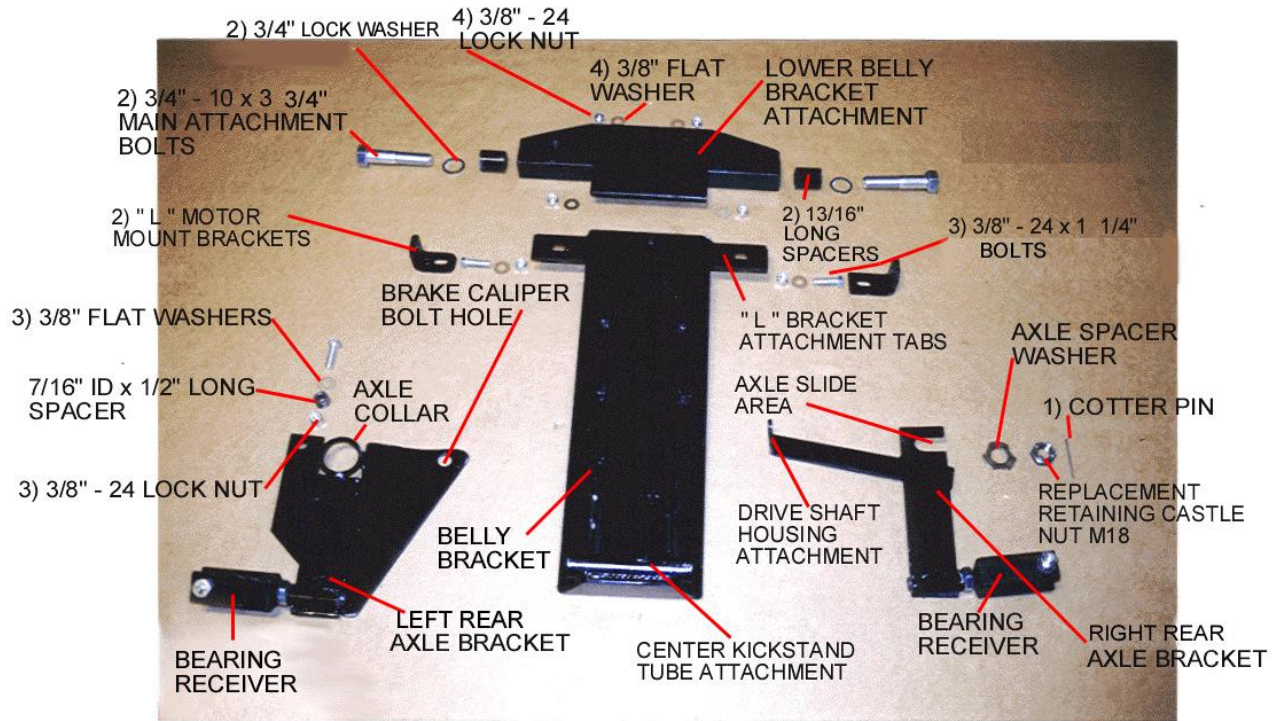

Two 3/8" washers used as shims– not shown in picture above.
You may or may not have to use the shims. See note below.

After installing the mounting hardware and attaching the Voyager frame to the belly bracket you may need shims to make the motorcycle stand straight up and down.
The shims may be used on either the left or the right side depending on which way the motorcycle is leaning. If the motorcycle is leaning to the left put the shims on the left side. If the motorcycle is leaning to the right put the shims on the right side.

Place shims over 3/8" holes on top of lower belly bracket. Shims may be used on either the left or right side depending on which way bike is leaning. Install lower belly bracket to belly bracket.

SECTION 1

INSTALLATION OF HONDA GOLDWING 1000cc MOUNTING HARDWARE

Place motorcycle on a clean flat surface. Be sure to tie down motorcycle so it does not tip over during installation of Voyager hardware. Installation is easier if motorcycle is in an upright position.

Disconnect negative cable from battery before beginning installation.

NOTE: The Voyager Convertible Kit was designed for a stock motorcycle from the manufacturer. Any after market products that are on a stock motorcycle may cause the installation process to not be done properly and may or may not need to be removed to be able to install the Voyager Convertible Kit completely. Be aware that your motorcycle and the same make & model as someone else's motorcycle may not have mufflers, body panels, frames, fenders and any other manufacturer parts that are attached to the motorcycle in the exact same place as yours. We at Motorcycle Tour Conversion, Inc. take that into consideration when we manufacture our parts to fit your motorcycle. Once in awhile you may need to modify your motorcycle slightly so that the Motorcycle Tour Conversion, Inc. hardware or suspension fits your motorcycle. Please call Motorcycle Tour Conversion, Inc. if you have any questions about installation with after market products or any modification of motorcycle and/or Motorcycle Tour Conversion, Inc. hardware.

A) BELLY BRACKET

1. Remove complete exhaust system
2. Remove center stand
3. Remove everything except front roll bar from front motor mount
4. Place the two "L" brackets (one on each side) on the front motor mount bolt. The "L" brackets must have 3/8"-24 x 1 1/4" bolts and flat washers through the bottom hole, head up, before installation.

NOTE: If the front motor mount bolt is too short you can replace it with a 13 1/2" long section of 3/8" all thread rod that may be purchased from your local hardware store.

5. Lift rear of belly bracket (tube end) to center stand mounting brackets and bar through the kickstand brackets and belly bracket. Reinstall the center stand.
6. Then tighten the (2) kick stand bracket bolts.
7. Lift front of belly bracket to the "L" brackets (front motor mounts) and attach with the 2) 3/8" - 24 lock nuts bolts that are provided with this kit.

SECTION 1

INSTALLATION OF HONDA GOLDWING 1000cc MOUNTING HARDWARE

8. Install lower belly bracket to the belly bracket with the 4) 3/8" flat washers, and 4) 3/8"-24 lock nuts.
9. Tighten all belly bracket bolts and nuts at this time.

B) REAR AXLE BRACKETS

RIGHT SIDE:

- 1) Remove cotter pin and axle retaining nut.
- 2) Remove outside drive shaft housing nut.
- 3) Place axle spacer washer over axle.
- 4) Place right rear axle bracket on the axle bolt and on the drive shaft housing bolt, replace and tighten drive shaft housing nut.
- 5) Using the castle nut provided with the kit, tighten rear axle and replace the cotter pin.

NOTE: Remove the rear brake caliper retaining bolt.

LEFT SIDE:

- 1) Slide axle collar over axle shaft end.
- 2) Place brake caliper bolt hole of left rear axle bracket over brake caliper bolt of motorcycle. Replace retaining nut. (Do Not Tighten at this time.)
- 3) Place swing arm attachment bolt through swing arm mounting hole and axle bracket swing arm attachment hole.

NOTE: Depending on your bike you may need the 1/2" spacer provided so that the axle bracket is straight. Align with rear of motorcycle. (spacer goes in between swing arm mounting hole and left rear axle bracket.)

- 4) Tighten both attachment nuts at this time.

SECTION 1
INSTALLATION OF HONDA GOLDWING 1000cc
MOUNTING HARDWARE



MOTORCYCLE TOUR CONVERSION, INC.
1530 TITANIUM DRIVE
OTTAWA, IL 61350

TOLL FREE: 877-434-7901
FAX: 815-434-8980

HONDA GOLDWING 1000

INSTALLATION MANUAL
US PATENT # 6,739,420

**WARRANTY WILL BE VOID IF INSTALLATION
IS NOT DONE PROPERLY**

**READ THIS MANUAL FULLY BEFORE
BEGINNING INSTALLATION OR DRIVING YOUR
MOTORCYCLE WITH THE VOYAGER KIT ATTACHED**